

Courses up Monongahala }
Beg. at a Sugar & Running }

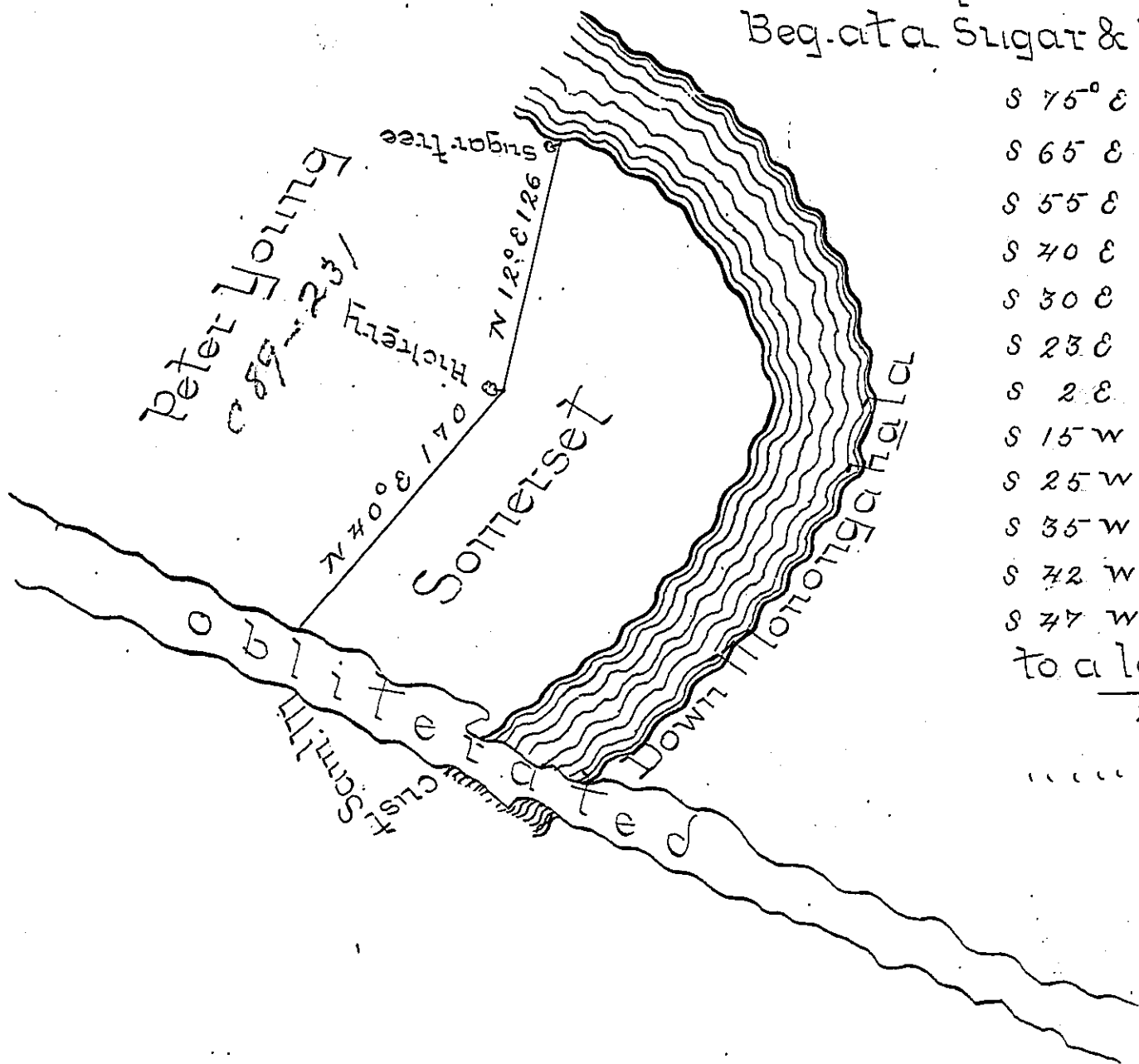

- S 75° E 20 P
- S 65 E 20 P
- S 55 E 32 P
- S 40 E 27 P
- S 30 E 25 P
- S 23 E 28 P
- S 2 E 26 P
- S 15 W 20 P
- S 25 W 32 P
- S 35 W 27 P
- S 42 W 28 P
- S 47 W 153 P
- to a locust
- 435

In pursuance of an order No 3770 dated 26th August 1769. the above is a draft of a tract of land call'd Somerset, situated on the west side Monongahala Containing 210.3.12 acres with the usual allowance of 6 P.C. for Roads highways, &c: obl. veid for George M Collock 1st November 1769. by

James Hendricks

Joh obl'td. - ns Esq^r
obl'td. - veyor General

IN TESTIMONY that the above is a copy of the original remaining on file in the Department of Internal Affairs of Pennsylvania, made conformably to an Act of Assembly approved the 16th day of February, 1833, I have hereunto set my Hand and caused the Seal of said Department to be affixed at Harrisburg, this sixth day of November 1899.

James W. Latta
Secretary of Internal Affairs.